

# Prime Railway Services

www.primerailway.com

## Shims, Plates & Brackets

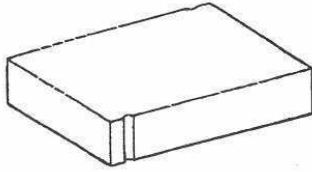

FOLLOWER DRAFT GEAR  
Part #5033

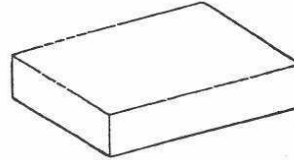

FOLLOWER DRAFT GEAR  
Part # 5100

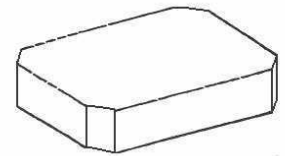

COUPLER FOLLOWER  
PLATE  
Part # 5101

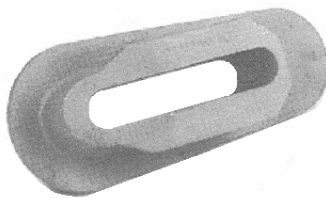

KEY SLOT REINFORCEMENT  
Part # 5105

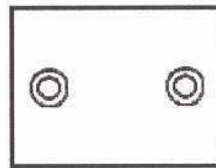

COLUMN WEAR PLATE  
Part # 3139 – 5" x 8-1/2"  
Part # 3140 – 5-1/2" x 8-1/2"  
Part # 3141 – 7-1/2" x 9-7/16"

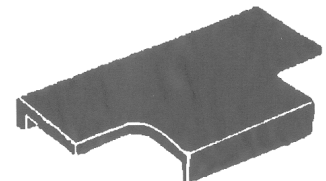

COUPLER WEAR PLATE  
Part # 3136

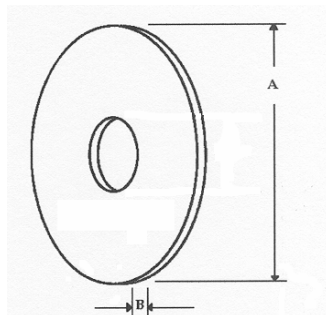

CENTRE PLATE SHIM

- Part # 3128 A=11-1/2", B=1/8", ID=3-3/8"
- Part # 5093 A=11-1/2", B=1/8", ID=3-5/8"
- Part # 3123 A=11-1/2", B=1/8", ID=3-5/8"
- Part # 3124 A=11-1/2", B=3/16", ID=3-5/8"
- Part # 3125 A=11-1/2", B=1/4", ID=3-5/8"
- Part # 5089 A=13-1/2", B=1/8", ID=3-5/8"
- Part # 3122 A=13-1/2", B=1/4", ID=3-5/8"
- Part # 3121 A=13-1/2", B=3/16", ID=3-5/8"
- Part # 3129 A=13-3/4", B=1/8", ID=3-3/8"
- Part # 3126 A=13-3/4", B=1/4", ID=3-3/8"
- Part # 3119 A=14-1/2", B=1/8", ID=3-5/8"
- Part # 3127 A=15-3/4", B=1/4", ID=3-3/8"



SIDE BODY SHIM  
Part # 4303-14" long



BODY SIDE BEARINGS  
Part # 5302-1 18" long  
Part # 5302 18-1/4" long  
Part # 5301 20-1/2" long  
Part # 5310 21" long

# Prime Railway Services

www.primerrailway.com

## Shims, Plates & Brackets



SHIMS

	Thickness	Width	Length
Part # 3101	1/4"	3" x	9"
Part # 3102	1/2"	3" x	10"
Part # 5320	1/8"	4-1/4" x	10-1/4"
Part # 5321	1/4"	4-1/4" x	10-1/4"
Part # 5322	3/8"	4-1/4" x	10-1/4"
Part # 5323	1/2"	4-1/4" x	10-1/4"
Part # 5328	1/8"	4" x	10-1/2"
Part # 5329	1/4"	4" x	10-1/2"
Part # 5330	3/8"	4" x	10-1/2"
Part # 5331	1/2"	4" x	10-1/2"
Part # 3103	1/4"	3-1/2" x	11"
Part # 5324	1/8"	4-1/2" x	13-1/2"
Part # 5325	1/4"	4-1/2" x	13-1/2"
Part # 5326	3/8"	4-1/2" x	13-1/2"
Part # 5327	1/2"	4-1/2" x	13-1/2"
Part # 5312	16 GA	4" x	18"
Part # 5313	1/8"	4" x	18"
Part # 5314	3/16"	4" x	18"
Part # 5315	1/4"	4" x	18"
Part # 5316	5/16"	4" x	18"
Part # 5317	3/8"	4" x	18"
Part # 5318	7/16"	4" x	18"
Part # 5319	1/2"	4" x	18"
Part # 3110	1/8"	5" x	20"
Part # 3111	1/4"	5" x	20"
Part # 3112	3/8"	5" x	20"
Part # 5332	1/8"	4" x	21"
Part # 5333	1/4"	4" x	21"
Part # 5334	3/8"	4" x	21"
Part # 5335	1/2"	4" x	21"



SHIMS

	Thickness	Width	Length
Part # 3131	16 GA	7" x	12"
Part # 3131-A	1/8"	7" x	12"
Part # 3131-B	3/16"	7" x	12"
Part # 3131-C	1/4"	7" x	12"
Part # 3131-D	5/16"	7" x	12"
Part # 5303	16 GA	4" x	18"
Part # 5304	1/8"	4" x	18"
Part # 5305	3/16"	4" x	18"
Part # 5306	1/4"	4" x	18"
Part # 5307	5/16"	4" x	18"
Part # 5308	3/8"	4" x	18"
Part # 5309	1/2"	4" x	18"
Manganese			
Part # 3134	3/8"	3" x	7"
Part # 3135	1/4"	3" x	7"
Part # 3132	3/8"	3" x	21"
Part # 3133	1/4"	3" x	21"

**OTHER SIZES & TYPES AVAILABLE**

**PLEASE CONTACT OUR SALES TEAM!**